

## Miniature light scanners with background blanking

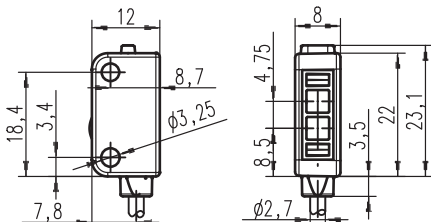

### Dimensioned drawing



### Electrical connection

|             |   |       |
|-------------|---|-------|
| 10-30V DC + | 1 | br/BN |
| GND         | 2 | bl/BU |
| OUT 1       | 4 | sw/BK |

### Specifications

|                                |                                       |
|--------------------------------|---------------------------------------|
| Scanning range                 |                                       |
| Light beam characteristic      |                                       |
| Operating voltage $U_B$        | 10 ... 30VDC                          |
| Switching output <sup>1)</sup> | OUT1 (pin 4): NPN                     |
| Output current                 | 50mA (per output and total)           |
| Function .../2                 | OUT1: switching                       |
| Connection type                | 150 mm cable with M8 connector, 3-pin |
| Switching frequency            | 590Hz                                 |
| Ambient temperature            | -20 ... +55°C (operation)             |
| Protection class               | IP 67                                 |

1) Bipolar transistor, open collector

### Operate in accordance with intended use!

- ⚠ This product is not a safety sensor and is not intended as personnel protection.
- ⚠ The product may only be put into operation by competent persons.
- ⚠ Only use the product in accordance with the intended use.



Detailed data sheets:  
[www.leuze.com](http://www.leuze.com)



## Barcode ID