

Diffuse sensors with background suppression

OHDK 10 (Laser)

sample drawing

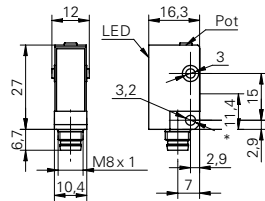

* emitter axis

general data

type	background suppression
light source	pulsed red laser diode
sensing distance T_w	22 ... 130 mm
sensing range T_b (at T_w max.)	3 ... 130 mm
sensing range T_b (at T_w min.)	3 ... 22 mm
repeat accuracy	< 0,2 mm at laser focus
light indicator	LED yellow
power on indication	LED green
sensing distance adjustment	mechanical, 5 turn
laser class	2
distance to laser focus	40 mm
wave length	650 nm
suppression of reciprocal influence	yes

electrical data

response time / release time	< 0,25 ms
voltage supply range +Vs	11 ... 30 VDC
current consumption max.	30 mA
current consumption typ.	25 mA
voltage drop V_d	< 1,8 VDC
output function	light / dark operate
short circuit protection	yes
reverse polarity protection	yes, supply only

mechanical data

width / diameter	10,4 mm
height / length	27 mm
depth	16,3 mm
type	rectangular
housing material	plastic (ASA)
front (optics)	PMMA

ambient conditions

operating temperature	-10 ... +50 °C
-----------------------	----------------

sample picture



laser warning



**Diffuse sensors with
background suppression****OHDK 10 (Laser)**

order reference	connection types	output circuit	protection class	output current
OHDK 10N5101	cable 4 pin, 2 m	NPN	IP 65	< 70 mA
OHDK 10N5101/S35A	connector M8 4 pin	NPN	IP 67	< 70 mA
OHDK 10P5101	cable 4 pin, 2 m	PNP	IP 65	< 100 mA
OHDK 10P5101/S35A	connector M8 4 pin	PNP	IP 67	< 100 mA

Diffuse sensors with background suppression

OHDK 10 (Laser line beam)

sample drawing

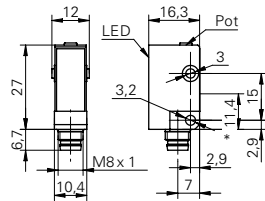

* emitter axis

general data

type	background suppression
version	line beam
light source	pulsed red laser diode
sensing distance T_w	22 ... 130 mm
sensing range T_b (at T_w max.)	3 ... 130 mm
sensing range T_b (at T_w min.)	3 ... 22 mm
repeat accuracy	< 0,2 mm at laser focus
light indicator	LED yellow
power on indication	LED green
sensing distance adjustment	mechanical, 5 turn
laser class	2
distance to laser focus	40 mm
wave length	650 nm
suppression of reciprocal influence	yes

electrical data

response time / release time	< 0,25 ms
voltage supply range +Vs	11 ... 30 VDC
current consumption max.	30 mA
current consumption typ.	25 mA
voltage drop V_d	< 1,8 VDC
output function	light / dark operate
short circuit protection	yes
reverse polarity protection	yes, supply only

mechanical data

width / diameter	10,4 mm
height / length	27 mm
depth	16,3 mm
type	rectangular
housing material	plastic (ASA)
front (optics)	PMMA
connection types	connector M8 4 pin

ambient conditions

operating temperature	-10 ... +50 °C
protection class	IP 67

sample picture



laser warning



**Diffuse sensors with
background suppression****OHDK 10 (Laser line beam)**

order reference	output circuit	output current
OHDK 10N5150/S35A	NPN	< 70 mA
OHDK 10P5150/S35A	PNP	< 100 mA