

## Diffuse sensors with intensity difference

### FZDK 20

#### sample drawing

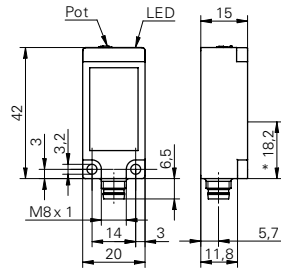

\* emitter axis

#### general data

type	intensity difference
light source	pulsed red LED
sensing distance $T_w$	5 ... 500 mm
alignment / soiled lens indicator	flashing light indicator
light indicator	LED yellow
sensitivity adjustment	potentiometer, 270°
wave length	660 nm
suppression of reciprocal influence	yes

#### electrical data

response time / release time	< 0,5 ms
voltage supply range +Vs	10 ... 30 VDC
current consumption max.	25 mA
current consumption typ.	22 mA
voltage drop Vd	< 1,8 VDC
output function	light / dark operate
output current	< 100 mA
short circuit protection	yes
reverse polarity protection	yes

#### mechanical data

width / diameter	20 mm
height / length	42 mm
depth	15 mm
type	rectangular
housing material	plastic (PBT-ASA)
front (optics)	PMMA
connection types	connector M8 4 pin

#### ambient conditions

operating temperature	-25 ... +65 °C
protection class	IP 67

#### order reference

FZDK 20N5101/S35A
FZDK 20P5101/S35A

#### output circuit

NPN
PNP

#### sample picture

